

AMPLIFIERS

PA AND 2-CHANNEL AMPLIFIERS

STA-750



STA-700



STA-201



Mounting height of 1 RS only!

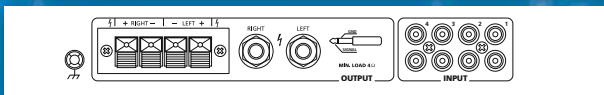

PC&Musik 06/2006

"Provides an overall well-balanced sound with decent reserves."

STA-121



Mounting height of 1 RS only!

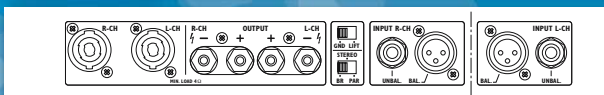

PROSOUND 03/2006

"A very practice-orientated unit of high quality. Easy-to-use, a must-have, and useful - to be recommended!"

STA-102

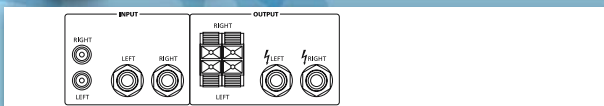

STA-750

Order No. 25.1950

Stereo PA amplifier, for stage and DJ applications. 1,000 W_{MAX} • Fan-cooling • Speaker switch-on delay • Protected against short circuit, overheating, and DC voltage overlay at the outputs due to protective circuit with LED indication • 2 level controls • 1 LED per channel for overload (clip) • Groundlift switch

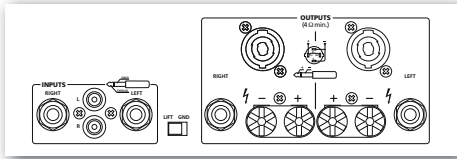

STA-700

Order No. 24.4120

Stereo PA amplifier, for stage and DJ applications. 800 W_{MAX} • Fan-cooling • Speaker switch-on delay • Protected against short circuit, overheating, and DC voltage overlay at the outputs due to protective circuit with LED indication • 2 level controls • 1 LED per channel for overload (clip) • Groundlift switch

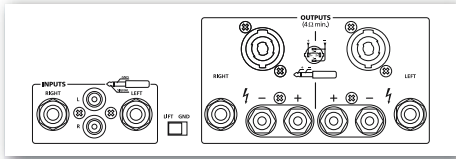

STA-500

Order No. 24.3970 Same picture as STA-700

Stereo PA amplifier, for stage and DJ applications. 600 W_{MAX} • Fan-cooling • Speaker switch-on delay • Protected against short circuit, overheating, and DC voltage overlay at the outputs due to protective circuit with LED indication • 2 level controls • 1 LED per channel for overload (clip) • Groundlift switch

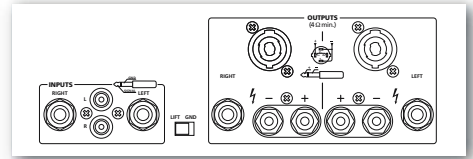

Model	STA-750	STA-700	STA-500
Output power			
RMS power			
Stereo 4Ω	2 x 350W _{RMS}	2 x 275W _{RMS}	2 x 200W _{RMS}
Stereo 8Ω	2 x 270W _{RMS}	2 x 200W _{RMS}	2 x 125W _{RMS}
Max. power	1,000W _{MAX}	800W _{MAX}	600W _{MAX}
General information			
Inputs	0.85V/55kΩ	0.85V/55kΩ	1.3V/55kΩ
Frequency range	10-20,000Hz	10-20,000Hz	10-20,000Hz
S/N ratio	85dB	85dB	64dB
Crosstalk attenuation	> 43dB	> 43dB	> 55dB
THD	< 0.05%	< 0.05%	< 0.05%
Power supply	230V~/50Hz/1,800VA	230V~/50Hz/1,100VA	230V~/50Hz/730VA
Admiss. ambient temp.	0-40 °C	0-40 °C	0-40 °C
Dimensions	482x98x296mm, 2RS	482x98x296mm, 2RS	482x95x300mm, 2RS
Weight	11kg	11kg	9.3kg
Inputs	1 x 6.3mm jack L/R, 1 x RCA L/R	1 x 6.3mm jack L/R, 1 x RCA L/R	1 x 6.3mm jack L/R, 1 x RCA L/R
Outputs	2 x SPEAKER 1 x 6.3mm jack L/R 2 x pair of screw terminals	2 x SPEAKER 1 x 6.3mm jack L/R 2 x pair of screw terminals	2 x SPEAKER 1 x 6.3mm jack L/R 2 x pair of screw terminals

ATTENTION!

STA-121 and STA-102 are highly stable amplifiers of high power capabilities and are very suitable for studio, PA, and even stage applications. They can also perfectly be used e.g. in home HiFi systems or multichannel home cinema systems due to the fanless cooling concept and the excellent sound.

STA-201

Order No. 24.4660

Stereo PA amplifier

3 operational modes can be selected (stereo, parallel, or bridged) • Groundlift switch • Soft start, speaker switch-on delay • 2 temperature-controlled fans • 2 level controls • Protected against short circuit, overheating, and DC voltage overlay at the outputs due to protective circuit with LED indication • LEDs for overload, stereo operation, parallel operation, or bridge operation

Model	STA-201
Output power	
RMS power	
Stereo 4Ω	2 x 200W _{RMS}
Stereo 8Ω	2 x 140W _{RMS}
8Ω bridge operation	1 x 400W _{RMS}
Max. power	500W _{MAX}
General information	
Inputs	0.775V/20kΩ
Frequency range	10-20,000Hz
S/N ratio	> 75dB
Crosstalk attenuation	> 51dB
THD	< 0.05%
Power supply	230V~/50Hz/950VA
Admiss. ambient temp.	0-40 °C
Dimensions	482x50x350mm, 1RS
Weight	10kg
Connections	1 x XLR L/R 2 x 6.3mm jack L/R 2 x SPEAKER 2 x pair of screw terminals

STA-121

Order No. 24.3410

Stereo PA amplifier, with four switchable line inputs.

300 W_{MAX} • Silent operation due to fanless cooling concept • Protected against short circuit and overheating due to protective circuit • 2 level controls • LEDs for overload (clip) and protect

Model	STA-121
Output power	
RMS power	
Stereo 4Ω	2 x 110W _{RMS}
Stereo 8Ω	2 x 80W _{RMS}
Max. power	300W _{MAX}
General information	
Inputs	0.775V/10kΩ
Frequency range	20-20,000Hz
S/N ratio	> 70dB
Crosstalk attenuation	> 50dB
THD	< 0.5%
Power supply	230V~/50Hz/450VA
Admiss. ambient temp.	0-40 °C
Dimensions	482x45x285mm, 1RS
Weight	7.2kg
Inputs	4 x RCA L/R
Outputs	2 x 6.3mm jack, unbal. 1 x spring-load. speaker term. L/R

STA-102

Order No. 24.0960

2-channel amplifier

Silent operation due to fanless cooling concept • Speaker switch-on delay • Protected against short circuit and overheating • 2 level controls • Clip LEDs • 482mm (19") rack installation with fitted mounting brackets • RCA and 6.3mm jacks as stereo inputs, 6.3mm jacks and spring-loaded speaker terminals as stereo outputs

Model	STA-102
Output power	
RMS power	
Stereo 4Ω	2 x 60W _{RMS}
Stereo 8Ω	2 x 50W _{RMS}
8Ω bridge operation	-
Max. power	200W _{MAX}
General information	
Inputs	1V (max. 7V)/20kΩ
Frequency range	10-20,000Hz
S/N ratio	> 70dB
Crosstalk attenuation	> 50dB
THD	< 0.05%
Power supply	230V~/50Hz/310VA
Admiss. ambient temp.	0-40 °C
Dimensions	420x88x250mm, 2RS
Weight	7kg
Connections	1 x 6.3mm jack L/R 1 x RCA L/R 1 x 6.3mm jack L/R 1 x spr-load. speak. term. L/R

STA-1000S

Order No. 25.1930

new!

Stereo PA amplifier, with switch-mode PSU.
 1,300 W_{MAX} • Lightweight due to integrated switch-mode PSU • Selector switch for stereo operation or bridge operation • 2 level controls, 2 temperature-controlled fans • Protected against short circuit, overheating, and DC voltage • LEDs for signal, overload (clip), and activated protective circuit (protect) • NEUTRIK SPEAKON connections

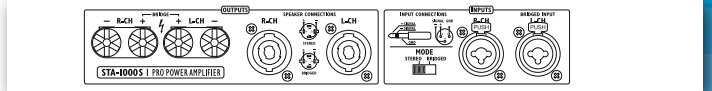
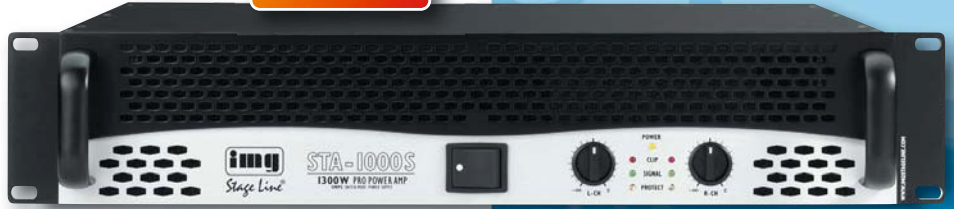

STA-142 600 W_{MAX}

Order No. 24.3380

STA-122 300 W_{MAX}

Order No. 24.3370

Same picture as STA-142

Stereo PA amplifiers, for stage and DJ applications.
 1 temperature-controlled fan • Protected against short circuit, overheating, and DC voltage overlay at the outputs due to protective circuit • 2 level controls • LEDs for overload (clip) and protect

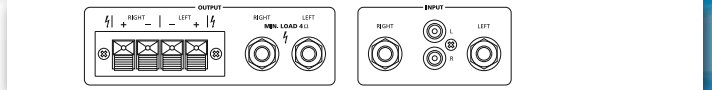

STA-1403

Order No. 24.4610

3-channel sat/sub full range professional amplifier, with integrated crossover network.
 Sat/sub amplifier or full range amplifier operation can be selected • Internal crossover network for sat/sub operation • Crossover network, adjustable crossover frequency 80/120/180 Hz • Bass boost function (+3 dB/+6 dB) • 2 temperature-controlled fans • Groundlift switch • Protected against short circuit and overheating • LEDs for signal, overload (clip), and activated protective circuit (protect) • NEUTRIK SPEAKON connections

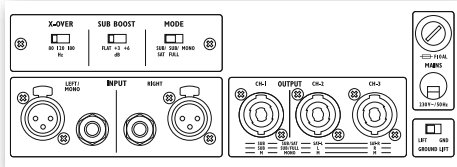

SOUNDCHECK

DAS FACHBLATT FÜR LIVE-MUSIKER

Soundcheck 07/2006

"Once again IMG Stage Line offers a really reliable unit which is very suitable for typical applications. A more convenient solution than the STA-1403 at a more attractive price can hardly be imagined."

tools

MAGAZIN FÜR MUSIK UND EQUIPMENT

tools4music 05/2006

"Recommendable! The features of this power amplifier are simply perfect. Suitable for most versatile applications."

Model	STA-1000S
Output power	
RMS power	
Stereo 4Ω	2 x 420W _{RMS}
Stereo 8Ω	2 x 320W _{RMS}
8Ω bridge operation	1 x 900W _{RMS}
Max. power	1 x 1,300W _{MAX}
General information	
Inputs	1V/47kΩ
Frequency range	25-25,000Hz/-1dB
S/N ratio	> 70dB
Crosstalk attenuation	> 50dB
THD	< 0.5%
Power supply	230V~/50Hz/1,900VA
Admiss. ambient temp.	0-40 °C
Dimensions	482x88x495mm, 2RS
Weight	9.8kg
Connections	2 x comb. jack XLR/6.3mm 2 x NEUTRIK Speakon 2 x pair of screw terminals

Model	STA-142	STA-122
Output power		
RMS power		
Stereo 4Ω	2 x 200W _{RMS}	2 x 120W _{RMS}
Stereo 8Ω	2 x 140W _{RMS}	2 x 85W _{RMS}
Max. power	600W _{MAX}	300W _{MAX}
General information		
Inputs	0.775V/20kΩ	0.775V/20kΩ
Frequency range	10-20,000Hz	10-20,000Hz
S/N ratio	> 60dB	> 60dB
Crosstalk attenuation	> 35dB	> 35dB
THD	< 0.5%	< 0.5%
Power supply	230V~/50Hz/750VA	230V~/50Hz/450VA
Admiss. ambient temp.	0-40 °C	0-40 °C
Dimensions	482x95x350mm, 2RS	482x95x350mm, 2RS
Weight	12kg	9kg
Inputs	1 x RCA L/R 2 x 6.3mm jack, unbal.	1 x RCA L/R 2 x 6.3mm jack, unbal.
Outputs	2 x 6.3mm jack, unbal. 1 x spring-load. speaker term. L/R	2 x 6.3mm jack, unbal. 1 x spring-load. speaker term. L/R

Model	STA-1403
Output power	
RMS power	
Subwoofer 4Ω	1 x 400W _{RMS}
Subwoofer 8Ω	1 x 250W _{RMS}
Satellite 4Ω	2 x 250W _{RMS}
Satellite 8Ω	2 x 175W _{RMS}
Max. power	1,600W _{MAX}
General information	
Inputs	0.775V/30kΩ
Frequency range	20-20,000Hz
Crossover frequency	80Hz/120Hz/180Hz
Bass boost	+3dB/+6dB
S/N ratio	> 60dB
Crosstalk attenuation	> 50dB
THD	< 0.1%
Power supply	230V~/50Hz/1,800VA
Admiss. ambient temp.	0-40 °C
Dimensions	483x90x390mm, 2RS
Weight	15kg
Connections	2 x 6.3mm jack, bal. 2 x XLR, bal. 3 x NEUTRIK SPEAKON