

EDUCATION LCD PROJECTORS

INNOVATE
The Future of Projection

- ▶ ED-D10N/ED-D11N
- ▶ ED-A101/ED-A111
- ▶ ED-X26
- ▶ ED-AW100N/ED-AW110N
- ▶ ED-X50/ED-X52
- ▶ ED-X45N

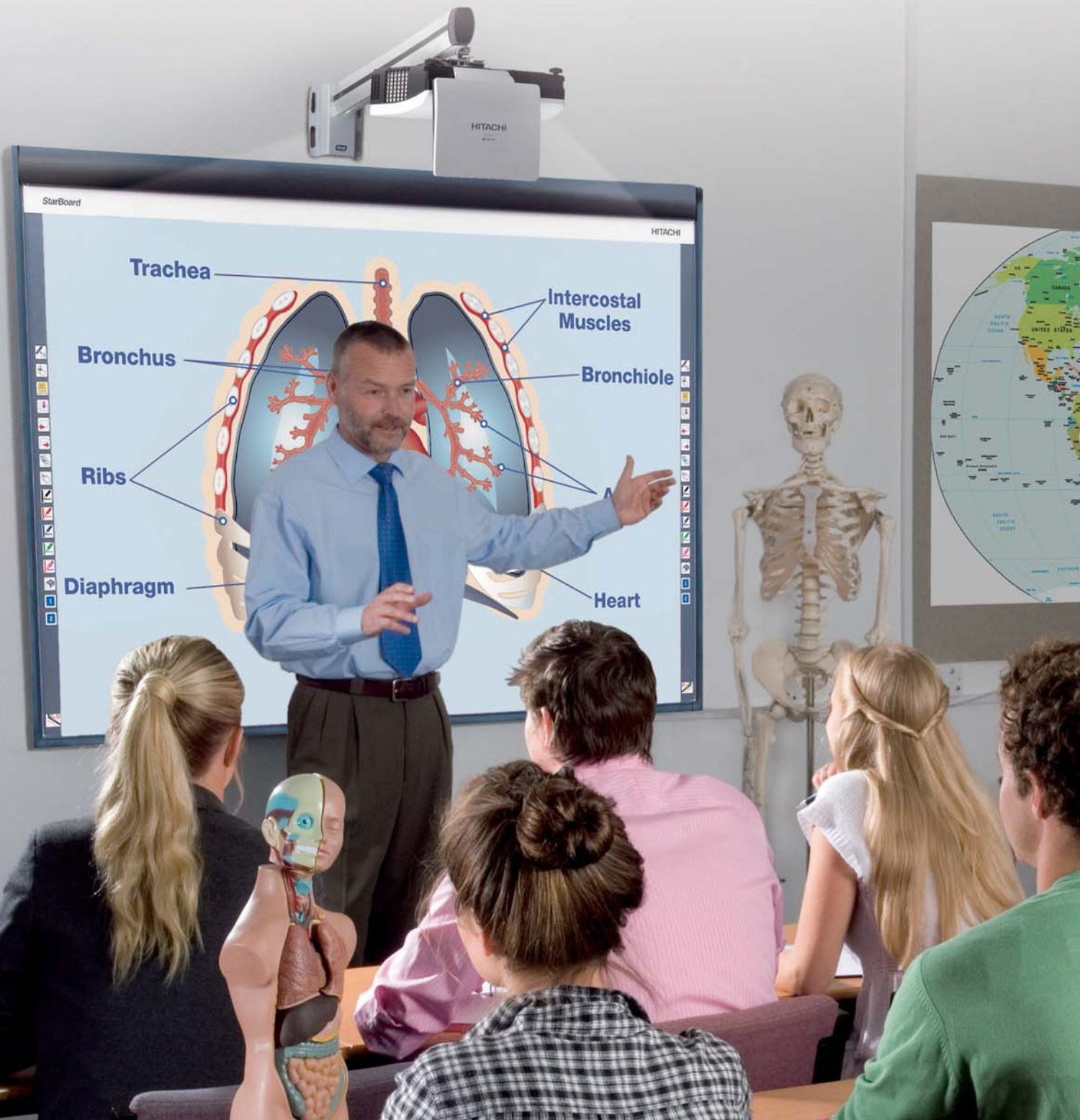

HITACHI
Inspire the Next

► Why buy Hitachi?



SECURITY

You don't have to worry about security. Hitachi education projectors come with multi-level PIN-Locks, transition Detector, steel security bar, Kensington Lock point and a distinctive orange-for-education coloured casing option.



EASY TO USE

Plug in, turn on and teach. Hitachi projectors have a quick on/off feature, automatic resolution and a user-friendly teachers' remote control allowing you to concentrate on what matters - the lesson.



ECO-FRIENDLY

Hitachi's education projectors feature long life lamps and extended hybrid filters which significantly increases maintenance intervals, reducing the amount of electronic waste and protecting the environment.

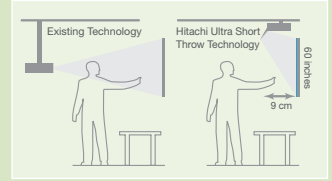

NO GLARE OR SHADOWS

Traditional projectors dazzle people, Hitachi's unique Ultra Short Throw Technology means if you stand in front of the projector the light beam won't shine in your eyes. (Short and Ultra Short Throw models)



SAVINGS

Significantly extended maintenance intervals resulting from long-life parts reduces the total cost of ownership.

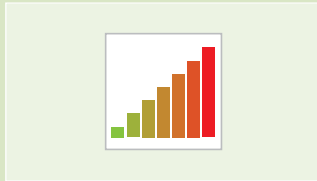

QUIET

With a low noise level of 29dB in our latest models, the internal fan is one of the quietest in its class. The audience will hear the presenter, not the operating noise of the projector.

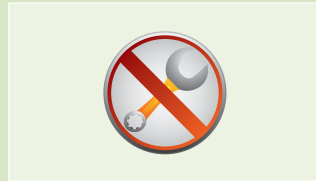

LOW MAINTENANCE

Hitachi projectors are designed to be easy to use and require minimal maintenance. Long-life parts significantly extend the maintenance intervals, reducing cost and any inconvenience.



SAFE FOR YOUNG EYES

All Hitachi's education projectors have been designed with British Educational Communications and Technology Agency (BECTA) and Health and Safety Executive (HSE) standards in mind.

► Virtually maintenance-free



Hitachi projectors are stylish, practical and cutting-edge – but we also work hard to ensure they are as green as

possible at every stage of their lifecycle.

That's why the 1W Standby Mode is an important new feature on all Hitachi projectors.

A new European Directive may soon limit the power consumption of projectors in standby to 1W or less. But at Hitachi, we're one step ahead. As part of our Environmental Vision, we've already ensured that all new projectors have this power-saving feature*. So from 2010, you'll save energy even if you need to leave your projector in Standby Mode.

This is one of many steps Hitachi is taking to help minimise our impact on the environment.

*Applies to all models listed overleaf except ED-A101 and ED-A111.

Hitachi's projectors use components which help in the overall reduction of their carbon footprint.



Super Hybrid Filter

The new Hitachi Super Hybrid Filter is the best you'll find on the market. It lasts up to an exceptional 6000 hours** – to make maintenance less frequent and reduce replacement costs.



Long lamp life

Now you can benefit from longer lamp life than ever before. Using Normal Mode, lamp life is extended up to 6000 hours – equivalent to the projector being used for three hours a day over a period of ten years.



Long filter life

A Hitachi filter should last as long as the projector lamp. And because replacement lamps come with a new filter, you can simply replace both at the same time, making it unnecessary to clean the filter.

** Applies to ED-X45N only.

Usability

Template function

This unique Hitachi feature allows you to project lines, grids and maps onto a whiteboard, blackboard or flip chart, to make writing and drawing and explaining easier.



(Applicable to the ED-X50, ED-X52 & ED-X26 only)

Input Source Naming

Now you can name your input sources so they're easier to understand and identify – for instance, 'S-Video' can become 'DVD player'.



Audio Pass Through

Audio Pass Through allows the user to listen to external speakers via the projector's audio output whilst in standby mode, so you are able to experience audio without images. This feature preserves the lamp life when you only need sound.

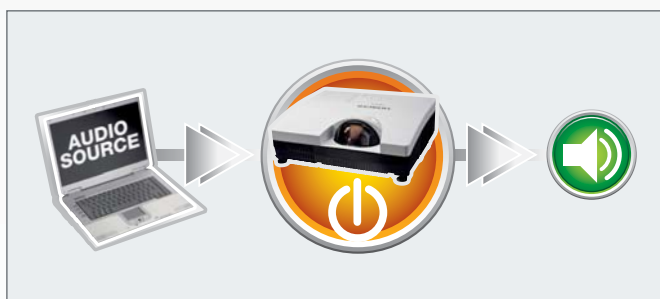

New OSD (On Screen Display) Menu Design

The new On Screen Display menu is now easier to use. The intuitive icons clearly identify the different functions and settings enabling easy navigation and installation.

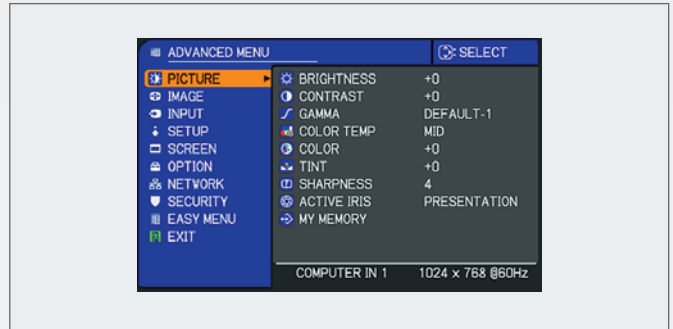

My Button

This customisable feature allows the user to assign a designated or frequently used function from the menu to this button. In addition the green button on the top of ED-X50, ED-X52 and ED-X26 enables the user to instantly clear the projection screen.



Vertical Keystone Correction

Correct misaligned images quickly and simply with vertical keystone correction.

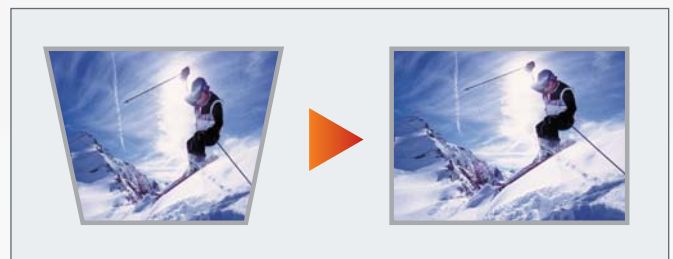

Zoom function

The new zoom function allows the user to select which area of their image they wish to enlarge. Great for teachers who wish to explain a particular part of a diagram in detail.

(Applicable to the ED-X50, ED-X52 and ED-X26 only)

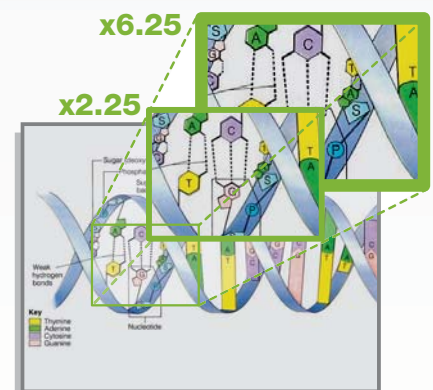



Make the most of your lessons with Hitachi Education Projectors

- ★ Built with teachers' needs and educational standards in mind
- ★ 3 year warranty for projector and lamp
- ★ Comprehensive security features to project against theft
- ★ Easy installation
- ★ Long life parts make these models virtually maintenance free
- ★ Reduced carbon footprint with extended service intervals
- ★ Advanced usability and network functions

▶ Outstanding picture quality

High picture quality

In this projector range, Hitachi brings together a variety of innovative features for superior picture quality. Motion Adaptive Progressive Scan reduces line flicker, boosting resolution and smoothing moving images. Noise Reduction boosts clarity. And Hitachi's unique Equalising Gamma Function helps you customise gamma and colour balance to suit your personal picture preferences.

Blackboard and Whiteboard Modes

Projecting onto coloured backgrounds can make images appear dull – whilst shiny backgrounds can make them uncomfortably bright. With our Blackboard and Whiteboard modes, you can ensure optimal brightness whether the screen is black, green or shiny white.

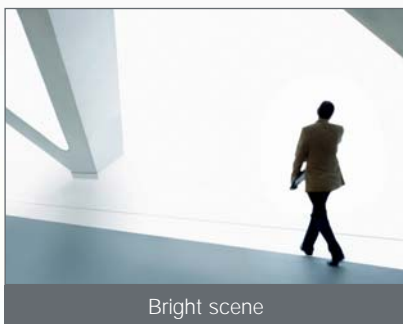

Bright scene

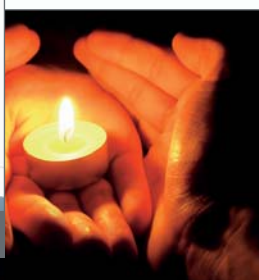

Dark scene



Normal

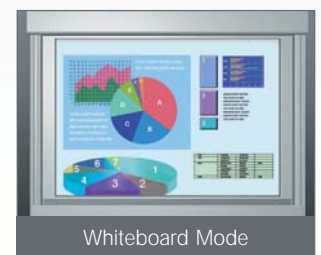

Whiteboard Mode

Advanced network functions (ED-D10N, ED-D11N, ED-AW100N, ED-AW110N and ED-X45N)

Messenger function

This clever function lets you send text to multiple, networked projectors instantly or at a specified time. This is ideal for projecting daily work schedules, university campus notifications, school activities or any information that needs to go out over a large area – fast.

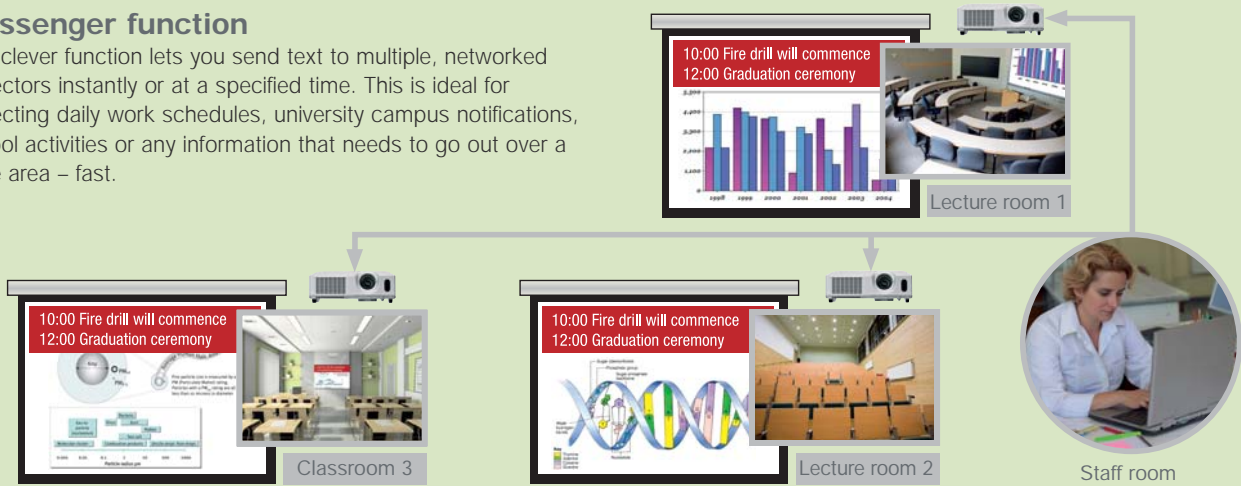

Convenient networking functions

Now you can manage and control multiple projectors over your LAN. The projector can monitor and diagnose its own status, as well as that of other network applications. You can also schedule

the projector to turn on and off automatically. And all of this functionality can be easily accessed via a web browser.

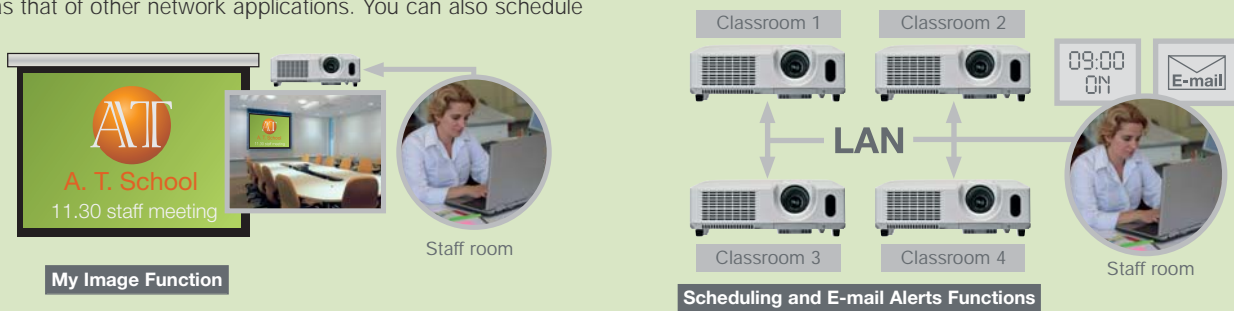

Centralised reporting functions

Using a single PC, you can create html reports for all your networked projectors. This can make maintenance simpler – for example, by revealing any projector that isn't working or any projectors that are due for maintenance.

| Model | IP | MAC | Connection | MAC Address |
|---------|---------------|-------------------|------------|-------------------|
| ED-D10N | 192.168.1.100 | 08:00:20:00:00:00 | LAN | 08:00:20:00:00:00 |
| ED-D10N | 192.168.1.101 | 08:00:20:00:00:00 | LAN | 08:00:20:00:00:00 |
| ED-D10N | 192.168.1.102 | 08:00:20:00:00:00 | LAN | 08:00:20:00:00:00 |
| ED-D10N | 192.168.1.103 | 08:00:20:00:00:00 | LAN | 08:00:20:00:00:00 |
| ED-D10N | 192.168.1.104 | 08:00:20:00:00:00 | LAN | 08:00:20:00:00:00 |
| ED-D10N | 192.168.1.105 | 08:00:20:00:00:00 | LAN | 08:00:20:00:00:00 |
| ED-D10N | 192.168.1.106 | 08:00:20:00:00:00 | LAN | 08:00:20:00:00:00 |
| ED-D10N | 192.168.1.107 | 08:00:20:00:00:00 | LAN | 08:00:20:00:00:00 |
| ED-D10N | 192.168.1.108 | 08:00:20:00:00:00 | LAN | 08:00:20:00:00:00 |
| ED-D10N | 192.168.1.109 | 08:00:20:00:00:00 | LAN | 08:00:20:00:00:00 |
| ED-D10N | 192.168.1.110 | 08:00:20:00:00:00 | LAN | 08:00:20:00:00:00 |
| ED-D10N | 192.168.1.111 | 08:00:20:00:00:00 | LAN | 08:00:20:00:00:00 |
| ED-D10N | 192.168.1.112 | 08:00:20:00:00:00 | LAN | 08:00:20:00:00:00 |
| ED-D10N | 192.168.1.113 | 08:00:20:00:00:00 | LAN | 08:00:20:00:00:00 |
| ED-D10N | 192.168.1.114 | 08:00:20:00:00:00 | LAN | 08:00:20:00:00:00 |
| ED-D10N | 192.168.1.115 | 08:00:20:00:00:00 | LAN | 08:00:20:00:00:00 |
| ED-D10N | 192.168.1.116 | 08:00:20:00:00:00 | LAN | 08:00:20:00:00:00 |
| ED-D10N | 192.168.1.117 | 08:00:20:00:00:00 | LAN | 08:00:20:00:00:00 |
| ED-D10N | 192.168.1.118 | 08:00:20:00:00:00 | LAN | 08:00:20:00:00:00 |
| ED-D10N | 192.168.1.119 | 08:00:20:00:00:00 | LAN | 08:00:20:00:00:00 |
| ED-D10N | 192.168.1.120 | 08:00:20:00:00:00 | LAN | 08:00:20:00:00:00 |
| ED-D10N | 192.168.1.121 | 08:00:20:00:00:00 | LAN | 08:00:20:00:00:00 |
| ED-D10N | 192.168.1.122 | 08:00:20:00:00:00 | LAN | 08:00:20:00:00:00 |
| ED-D10N | 192.168.1.123 | 08:00:20:00:00:00 | LAN | 08:00:20:00:00:00 |
| ED-D10N | 192.168.1.124 | 08:00:20:00:00:00 | LAN | 08:00:20:00:00:00 |
| ED-D10N | 192.168.1.125 | 08:00:20:00:00:00 | LAN | 08:00:20:00:00:00 |
| ED-D10N | 192.168.1.126 | 08:00:20:00:00:00 | LAN | 08:00:20:00:00:00 |
| ED-D10N | 192.168.1.127 | 08:00:20:00:00:00 | LAN | 08:00:20:00:00:00 |
| ED-D10N | 192.168.1.128 | 08:00:20:00:00:00 | LAN | 08:00:20:00:00:00 |
| ED-D10N | 192.168.1.129 | 08:00:20:00:00:00 | LAN | 08:00:20:00:00:00 |
| ED-D10N | 192.168.1.130 | 08:00:20:00:00:00 | LAN | 08:00:20:00:00:00 |

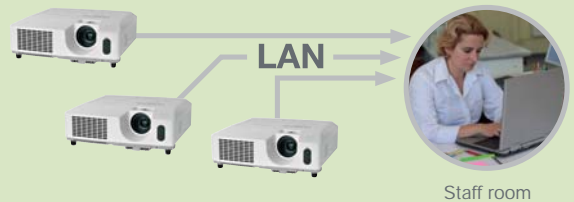

Security

Transition Detector

Hitachi's Education range is equipped with comprehensive security features to help protect your projector at all times.

If the projector is removed from its installed location, it triggers Hitachi's unique Transition Detector. This renders the projector inoperative unless a password is entered.

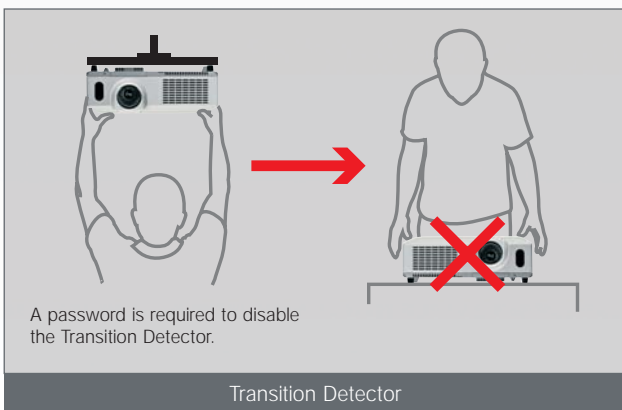

PIN-Lock

The projector PIN-Lock, ensures only authorised people can use the projector by entering their unique PIN code. This screen can be branded to your company or educational establishment using the MyScreen function.

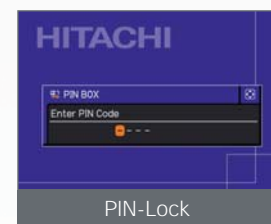

Security bar

For physical security, a chain can be added with ease.

Connectivity

You can connect the education range of projectors to a variety of devices, to support all your projection needs. From DVD players, monitors and PCs, to the Local Area Network and a simple mouse connection, Hitachi has done everything possible to create the most flexible user experience.

ED-D10N/ED-D11N

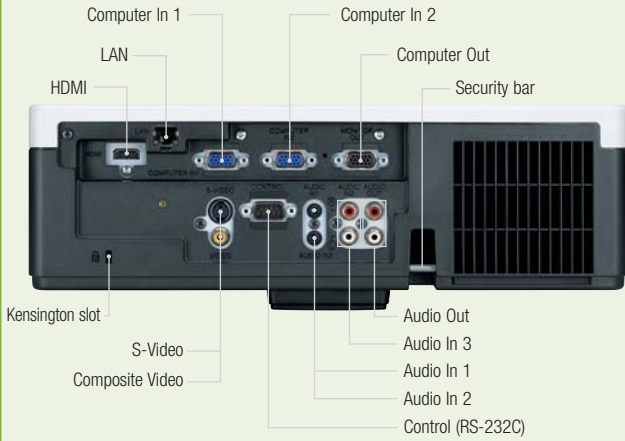

ED-X50/ED-X52

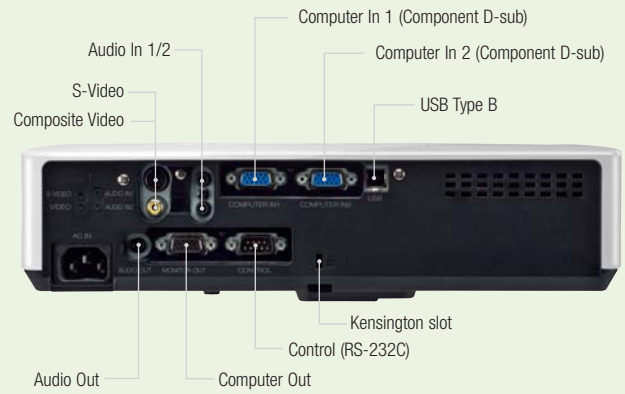

ED-AW100N/ED-AW110N

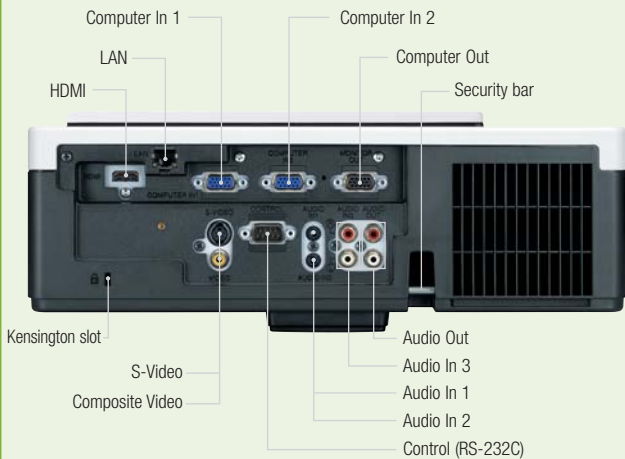

ED-X45N

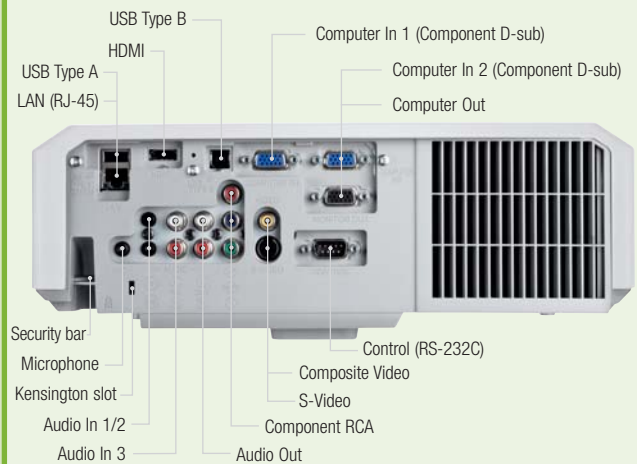

ED-A101/ED-A111

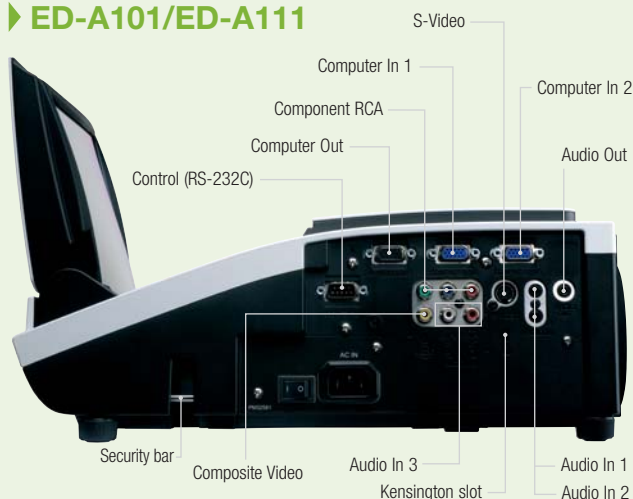

ED-X26

